



Forsyth County Joint Historic Properties Commission

APPLICATION
LOCAL HISTORIC LANDMARK DESIGNATION

1. Name of Property BURTON CRAIGE HOUSE
2. Owner's Name & Address CHRISTOPHER SHEAFFER & CINDY SHEAFFER
134 CASCADE AVENUE, WINSTON-SALEM
NC 27127
3. Property Location 134 CASCADE AVENUE, WINSTON-SALEM
4. Amount of Land To Be Designated (acreage) ± 1.3 ACRES
5. Interior To Be Designated _____ Yes _____ No
6. Tax Block(s) 674 Tax Lot (s) 101, 102
70 ~~1, 2, 13, 14, parts of 3, 10, 15~~

Please complete the following information on continuation sheets
REFER TO SEPERATE APPLICATION FORM

7. When was the structure erected? For Whom? (If you don't know the exact date, please give a general time frame.) Have there been additions or modifications? If so, describe and give dates.
8. Do you know the names of any of the craftsmen who worked on the structure? (i.e., architects, carpenters, contractors, landscape designers, etc.) Do any architect's plans or building accounts exist? Where?
9. Do you have any old photographs of the structure? If so, do you know the dates of the photographs?
10. How has the building been passed down through the years, from whom to whom? (i.e., a quick chain of title)

11. What was the structure's original use, if different from today? Has the building ever been moved? List the sources of your information.
12. What is the significance of this property? (Please be specific and to the point.) Include a list of sources for your information.
13. Describe the architecture and present condition of the structure, also including any outbuildings or other appurtenant features to be included in the designation. If the property has been restored, what were the dates of restoration? Was the restoration done under the supervision of any historic preservation organization? If the property has not been restored, is any restoration planned for the property?
14. Is the property listed in any existing architectural or historical survey (i.e., the National Register of Historic Places)? If so, please give the title and date of the listing.

In addition to the written application, the following materials must be submitted simultaneously:

- a black and white 8" x 10" overall photograph clearly depicting the property being designated
- color slides showing all sides of the main structure and any outbuildings (may include architectural details, interior and exterior, which add to the property's significance)
- a tax map showing the location of the property, including any outbuildings and appurtenant features

(Please label the above materials with the name of the property owner)

APPLICATION FEE \$50.00 (Check payable to Forsyth County)

The following information is true and correct to the best of my knowledge.

9-26-00
Date

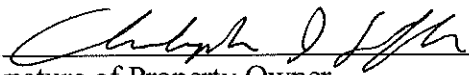
Signature of Property Owner

Mailing Address:
134 Cascade Ave
Winston-Salem NC 27127

Telephone: 

FORSYTH COUNTY JOINT HISTORIC PROPERTIES COMMISSION

- APPLICATION - LOCAL HISTORIC LANDMARK DESIGNATION

1. **Name of Property:** Burton Craige House, also known as the Brawley Estate.
2. **Owners' name and address:** Christopher I. and Cynthia D. Sheaffer,
134 Cascade Avenue,
Winston-Salem, North Carolina 27127
3. **Property Location:** 134 Cascade Avenue,
Winston-Salem, North Carolina 27127
4. **Amount of land to be designated (acreage):** + or - 1.3 acres.
5. **Interior to be designated:** Yes.
6. **Tax Blocks:** 10 tax lots: 1, 2, 13, 14, parts of 3, 12, and 15.
7. **When was the structure erected? For whom? Have there been additions or modifications? If so, describe and give dates.**

The house was originally built in the mid-19th century as a four-room farmhouse and was owned by a Banner, for whom Banner Avenue is presumed to have been named. Extensive remodeling has occurred at least twice. Between 1890 and 1905 a dining room and small den were added. In 1928 and 1929 the owners (Craiges) conducted a major remodeling. The earlier changes were removed, and the original house was overbuilt with a new living room, dining room, library, bedrooms, bathrooms, and sleeping porches. In 1930 a large gable-roofed framed garage with four car bays was built.

8. **Do you know the names of any craftsmen who worked on the structure? Do any architect's building plans or building accounts exist?**

The major remodeling that led to the current structure was designed by Luther Lashmit, a local architect. Landscaping was designed by Thomas Sears. Mr. Sears' original designs and sketches are in possession of the current owners. The current owners are not aware of any existing architectural plans for the house.

9. Do you have any old photographs of the structure?

No old photographs of the structure are in the possession of the current owners. The Winston-Salem library has an undated photograph in their archives.

10. How has the building been passed down through the years, from whom to whom?

The home was originally owned by a Banner. It was then occupied by Ms. Lydia W. Schouler and James W. Schouler (Ms. Schouler's son?) from 1912 to 1919, and then by James alone for one year until 1920, when the home was purchased by Burton Craige and his wife. Burton Craige moved to Winston-Salem from Salisbury, North Carolina, in 1911 to be legal counsel to R. J. Reynolds Tobacco Company. The home was purchased by the Brawleys in the early 1970's and was purchased from the Brawley Estate by the current owners in 1998.

11. What was the structure's original use, if different from today?

The home has always been a single-family residence.

12. What is the significance of this property?

The Burton Craige house is one of several grand houses built in Washington Park when the neighborhood was developed in the early 1900's. The neighborhood was considered to be one of the most prestigious turn-of-the-century neighborhoods in Winston-Salem. The suburb stands on one of the highest elevations in the city and initially featured a park with a lake and gazebo. The trolley line ran down South Main Street and met Cascade Avenue, and the neighborhood was very accessible to commuters. Therefore, many prominent industrialists and other businessmen built in the neighborhood to get away from the noise and pollution of the factories. The house features one of the first private swimming pools built in the town (approximately 1930) and has several distinctive interior features such as an elevator and a walk-in vault.

13. Describe the architecture and present condition of the structure, also including any outbuildings or other appurtenant features to be included in the designation.

The Burton Craige house is a large deck-hipped Colonial Revival house with one-story classical columned porches on each side, one with a pergola. The roof is slate.

There is a classical entrance porch containing a door with fan light and side lights. There are triple windows on the first floor and single 6/6 on the second floor. There are three hipped dormers.

The house has 17 rooms. There are 8 fireplaces. The floors of the house are oak with the exception of the dining room, which is intricately inlaid with various woods, and one small area which is floored in marble tiles. There are seven bedrooms and 6-1/2 bathrooms. Separate dining room, living room, breakfast room, sitting room, and family room exist. There are two kitchen areas with one designated the butler's kitchen. The house has several slate porches and patios.

In 1930 a four-bay garage and second floor apartment were built. Included in that building are two rooms creating as changing rooms for the swimming pool that was also built at that time. The garage, like the house, has a slate roof.

14. Is the property listed in any existing architectural and historical survey?

The Burton Craige House is listed in the Washington Park Historic District Application for the National Register of Historic Places. A copy of relevant excerpts from that application is included.

United States Department of the Interior
National Park Service

*Burton Craige Hse
file*

National Register of Historic Places
Continuation Sheet

Section number 7 Page 27

Washington Park Historic District
Forsyth County, NC

UNC Street # Date Height Property Name/Description/History If known

Cascade Avenue (continued)

on Park Blvd. and had the house moved there (see 14 Park Blvd), then built the present house. Eller (1861-1941) began practicing law in Winston-Salem with the firm of Eller and Starbuck in 1888 and was a leader in the trust field; trust officer with Wachovia Bank and Trust Company in 1916, later vice-president. Secretary and treasurer of the NC Railroad Company from 1903-1905, helped organize the Standard Bldg and Loan Association of W-S and was longtime president. In state senate from 1905-1907; chairman of state Democratic executive committee from 1908-1912; chairman W-S School Board, trustee of UNC, founder of NC Baptist Hospital, was a trustee of Slater Industrial Academy, later W-S State Teachers College (now WSSU) for 50 years since its founding in 1892, director of W-S Hotel Company. (SM, CD, TM, GT, I, N)

C 129-ob 1 1918 1 Pool House. Small gable-roofed brick building; gable end facing Broad Street is 6/1/6 common bond, engaged as a continuation of high brick wall along Broad Street.

[129-ob 2 See entry at 1821 Broad Street.]

C 134 1850s? & 1928-29 2 1/2 Burton Craige House. Large deck-hipped Colonial Revival house with one-story classical-columned porches at each side, one with pergola. Slate roof; classical entrance porch, door with fanlight and sidelights; triple windows on first floor, single 6/6 on 2nd floor, 3 hipped dormers. Stone retaining wall on Cascade Avenue side and on Broad Street side, curving around large tree; property extends to Banner Avenue. The house was originally built in the mid-19th century as a 4-room farmhouse and was owned by a Banner, for whom Banner Avenue is presumed to have been named. Then occupied by Mrs. Lydia W. Schouler, widow of David D. Schouler, and (her son?) James W. Schouler from 1912-1919, then by James alone for a year until 1920 when the Craiges bought it. Remodeled twice, first between 1890 and 1905 when a dining room and small den were added. In 1928 and 1929 the Craiges hired local architect Luther Lashmit to design a major remodeling, removing the earlier changes and over-building the remainder with a new living room, dining room, library, bedrooms and sleeping porches. A portion of the earlier house is visible. Landscaping was designed by Thomas Sears and a pool and poolhouse were added. Building's integrity is from that period. The Craiges moved to 102 Gloria and lived there for a year while work was underway. For many years the Craiges owned the land which is today 120 Cascade. Craige moved to Winston-Salem from Salisbury in 1911 to be legal counsel to R.J. Reynolds Tobacco Co. CDs list him in 1920-1922 as a lawyer first with Craige & Vogler law firm, by 1923 with Craige & Craige. (SM, CD, TM, GT, I, N, 1978 AIA Guide)

C 134-ob ca. 1930 1 1/2 Large gable-roofed frame garage with four car bays, each with half-glazed double doors; deck-hipped dormers above. Slate roof. Building permits indicate this was built around 1930 by "day labor". (BP)

C 134-str ca. 1929 n/a Concrete swimming pool designed as part of Thomas Sears's landscape plan. The Craiges frequently invited neighborhood children to swim here. (I)

(Broad intersects)

NC 201 1985 1 1/2 House. Steep side-gable frame house with entrance portico; sympathetic design. The three 1980s houses at #201, 203, and 205 are on site of the large Victorian Langenour-Fleshman House, demolished in 1967. Granite wall around Broad Street side of property remains. (TM, I)

WASHINGTON PARK HISTORIC DISTRICT SURVEY
ARCHITECTURAL RECORDING (by volunteers)

Recorder: Flemings

Date: 8-28-90

NAME OF BUILDING (to be completed later) _____

ADDRESS 134 Cascade

circle one: N S E W side of street

USE: residential commercial other _____

CONDITION: excellent good fair poor (severely deteriorated)

STYLE: (to be completed later) _____

HEIGHT: 1 story 1 1/2 story 2 story 2 1/2 story 3 story more

FACADE WIDTH: 1 bay 2 bay 3 bay 4 bay 5 bay 6 bay or more

CONSTRUCTION: frame load-bearing brick face brick stone other _____

WALL MATERIAL: weatherboard: plain/beaded brick: common bond/stretcher bond/Flemish bond

~~wood shingle:~~ placement (e.g. in front/side gable) _____ half-timbering stucco

board & batten German siding other _____

LATER SIDING: asphalt (eg brick pattern) asbestos aluminum vinyl

SHAPE OF MAIN ROOF: gable side gable front cross gable gambrel hip flat roof Jack hip

other, including decorative (tower, widow's walk, cupola) w/flat top

Use this space to explain complex roofs _____

ROOF MATERIAL: standing seam metal asphalt or composition shingle metal shingle

slate terra cotta tile concrete tile other _____

ORNAMENTATION OF MAIN ROOF: decorative brackets supporting roof: carved sawn grouped other _____

exposed rafters false knee bracing other _____

DORMER WINDOWS: gable gambrel shed hip eyebrow eyebrow vent

DORMER WIDTH: one sash two sash if more, describe _____

EAVES: wide overhang moderate overhang little or no overhang

Building address: 134 Cascade

FENESTRATION:

FRONT DOOR:

solid panelled (# =) glazed half-glazed other

DOORWAY:

sidelights (# on each side 6) transom fanlight; shape half ellipse

FRONT DOOR PLACEMENT:

central door left bay right bay other

WINDOWS:

NOTE: Concentrate on front windows for sash patterns; mention others if of interest.

double-hung sash: 6/6 2/2 1/1 9/1 6/1 vertical pane(e.g. 3/1) other

grouped sash: double/triple placement 6/4 metal casement stationary

modern "picture" window Palladian (placement)

bay window (placement)

WINDOW ARCHES:

flat or lintel jack arch round (segmental) arch elliptical arch

Other notes on windows:

FRONT PORCH

PORCH TYPE:

attached engaged inset recessed stoop (see decks at "ells")

PORCH WIDTH:

entrance bay only two bays three bays full front of house
slightly less than full front porch wraps on left side/right side/both

PORCH ROOF:

shed hip (one)-bay-wide front gable (portico) other

PORCH ROOF MATERIAL:

standing seam metal asphalt/compos shingle metal shingles

slate terra cotta tile concrete tile other

PORCH DETAILS:

tapered/square/round posts on brick/stone piers chamfered posts turned posts

classical columns sawn brackets turned brackets porte cochere

elaborate portico or entrance porch; describe: decorative brackets

OTHER PORCHES:

location: right side left side type: screen width: roof type: flat

roof material: porch details:

CHIMNEYS:

number: 1 2 3 4 5 or more

material: brick stone stucco other

placement: interior interior end (can't see) int. end w/ exposed face

exterior end (can see 3 sides) exterior front/rear interior rear
combination of int, exterior



Broad

Cascade

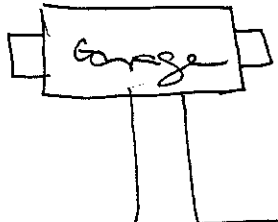
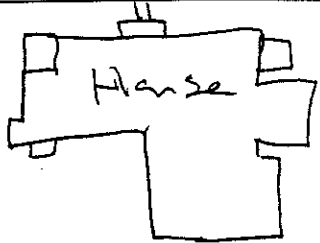

Banner

WASHINGTON PARK HISTORIC DISTRICT SURVEY CITY DIRECTORY RESEARCH

BUILDING (present-day address) 134 Cascade RESEARCHER LEO
 DATE 1991

TM 1900. (note is on 1917 SM. Joe mid 19th c. fan has recorded in 1900 +
 Start with 1923 directory using today's street number. Record name and all other information given. As you go back in date, you will have to follow the property by owner's name. Record the street number given in earlier directories, even though they are not the same as today's address.

Major remodel
 habit/Seas
 1928-9

Name of occupant: 1923 - Burton Craige (Joe) phone
Craige + Craige, attys Wash Bldg

Next city directory Date: 1922 / 1921 / 1920 phone
 Address in that directory: 134 / — / 1066 W 4th - d job - Craige + Ugle attys
 Name of occupant: same / Sarre / —

Next city directory Date:	<u>1920</u>	<u>1918</u>	<u>1916</u>
Address in that directory:	<u>—</u>	<u>—</u>	<u>Cascade corner Baswell (Broad)</u>
Name of occupant:	<u>James W. Schouler</u>	<u>same</u>	<u>same.</u>

dated
 " either + son
 in
 same has
 " 2 how
 on Cascade??

Next city directory Date: 1915 Also 1915
 Address in that directory: Cascade Ave Cascade - J. W. Schouler
 Name of occupant: Schouler, Lydia W. Mrs widm. David

Next city directory Date: 1913 Also 1913
 Address in that directory: Cascade Cascade
 Name of occupant: Lydia W Mrs, widm David D / J. W. Schouler

Page 2. Building Address (present-day): 134 Cascade

Next city directory Date: 1912 / Also 1912

Address in that directory: Cascade / Cascade

Name of occupant: Lydia etc same / Jos W Schouler - (no business listed, no wife)



Next city directory Date: 1911

Address in that directory: - Neither Lydia nor D.D. is listed.

Name of occupant: - Jos W. Schouler, salesman, rooms at YMCA.

in 1910, JWS = salesman, W. Merc. Co., rooms YMCA
in 1910, all other Schoulers are black. No Lydia
or DD is listed.

Next city directory Date: _____

Address in that directory: _____

Name of occupant: _____

Have Mr Banner

Next city directory Date: _____

Address in that directory: _____

Name of occupant: _____

Next city directory Date: _____

Address in that directory: _____

Name of occupant: _____

Next city directory Date: _____

Address in that directory: _____

Name of occupant: _____

Slides of 134 Cascade Avenue

- 1- View of front (north face) of house from the NW
- 2- View of east face of house (background) and pool
- 3- View of front (north) face of house
- 4- South face of house from the SE
- 5- South face of house
- 6- View of east face of house
- 7- West face of house (on Broad street)
- 8- South face of garage
- 9- North face of garage/pool house
- 10- "Jeffersonian" brick wall to south of house